



- - Directory - -

Super Sez .....	Pg 2
Danville Meet .....	Pg 3
KIT Report .....	Pg 4
Noblesville Judging Report .....	Pg 4
From the Judging Table .....	Pg 4
Lafayette Layout Tour .....	Pg 5
The Year was ?? .....	Pg 6
AP Engineer, Civil - Notice .....	Pg 7
Model Rails - Greatest People.....	Pg 7
The Depot .....	Pg 9
Weather or Not .....	Pg 9

- Division Schedule -

**Notice:** The **CID KIT (Kids In Trains) Clinic** will be held at all of our Meets. This is the young modelers 'Make and Take' Clinic where young modelers assemble a simple kit or other item with the aid of **N.M.R.A.** members. The **CID** furnishes both the kit or items to be assembled and the tools to work with. The completed project is theirs to take home.

**March 30, 2003 (Sunday) - Danville, IN - (See page 3 for details)**

4H Building, Hendricks County Fairgrounds

**Dealer Show & Meet - 10 AM to 3 PM -**

**CID Annual Meeting - 10:30 AM**

Layouts, Clinics and Contests: Photo and Model and **Favorite On-line Structure**

Admission - \$3.00 per person (children 12 & under free with an adult)

**For more information or tables call: Frank Hermanek at 317-487-6517**

**April 13, 2003 (Sunday) - Lafayette Layout Tour - (See page 5 for details)**

Meet at Hawkins Rail Services (He has moved)

**Layouts Open - Noon to 5 PM**

**Pick up maps beginning at 10:00 AM**

5 Layouts will be open for your viewing pleasure

**Summer Activity - To Be Announced**

**September 27, 2003 (Saturday) - Bedford, IN**

**Dealer Show & Meet - 11 AM to 3 PM**

**Extra Board**

**April 24, 25, 26, 27 2003**

**Titletown Express 2003 - Green Bay WI**

**Midwest Region, NMRA, Spring Meet**

Clinics, Tours, Contests & and Museum visits

**For Information and reservations:**

Mary Eiden

2229 Dixon Street, Stevens Point, WI 54481

**April 24, 25, 26, 27 2003**

**Springdale Express - Cincinnati OH**

**MCR, NMRA, Regional Convention**

Clinics, Tours, Contests & more

**Information:**

[www.cincy-div7.org/RegConv.html](http://www.cincy-div7.org/RegConv.html)

e-Mail: [rhord@juse.net](mailto:rhord@juse.net)

**October 3, 4 & 5 2003**

**Monon RR Historical-Technical Society**

Annual Meeting Brandywine Complex, Monticello, Indiana

<http://www.monon.org/>

Attention Clubs - Notices of club open houses will be included in the Division calendar upon notification in writing. Deadlines for each Spike are six weeks prior to each Division meet. Send info to Roger Hensley (see page 2). Include club name, address, date and time of function. Also include name, address and phone number of sponsor or contact.

# Super Sez

by Larry Gilbert

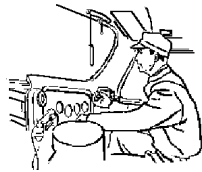

If you missed the Noblesville Meet this year you missed a good one. When I headed for Noblesville at 6:30AM the weather was nasty and by 9AM it was absolutely terrible. I 69 was closed for a while as they were cleaning up an accident, and the snow kept on coming down. The roads were very slick and it looked like we had a doomed meet on our hands.

I checked out the weather at 11:30AM and the street department of Noblesville had plowed the streets and the snow was melting. We had fifty people walk in the door in the first fifty minutes we were open. In fact they were standing in line waiting for us to open the door and they kept coming in all day long. Two Hundred and Fifty-three came through the door not counting all of the youngsters.

Thank you to the Noblesville Ledger for their very nice article (a full page article) about modeling railroading and to our members who were featured in the article and in pictures on the page. This turned out to be a very successful event for the CID. Thank you all who came and participated, to all who helped put it together and the dealers for showing their wares. If you missed us this time please come to Danville Sunday March 30<sup>th</sup> at the Hendricks County 4H Fair Grounds.

*Your CID Super  
Larry*

## An NMRA 2003 Calendar Photos Screen Saver is now Available

<http://www.nmra.org/saver.html>

or take the link on the CID Home Page at:

<http://cid.railfan.net/>



## COLUMBUS AREA RAILROAD CLUB, INC.

The Columbus Area Railroad Club is dedicated to serving all those interested in the preservation of railroad history through the use of modeling, photography, artifact preservation, and railfanning.

Regular monthly meetings are the first Thursday at 7 p.m.

Memberships are available.

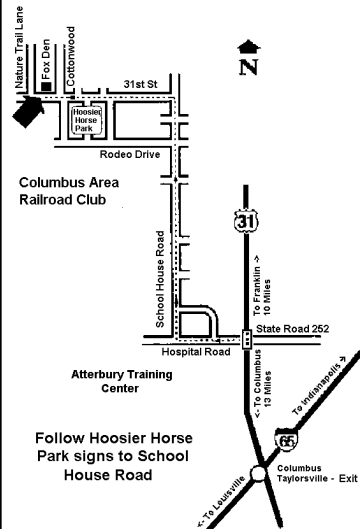

### Public Hours:

Second Saturday of  
the month

Noon to 4:00 p.m.  
Free admission

### Location:

Johnson County Park  
Fox Den  
6978 S. Cottonwood  
Edinburgh, IN

### Phone:

812-526-4855

The *RUSTY SPIKE* is the official publication of the Central Indiana Division, Midwest Region, National Model Railroad Association, and is published at least five times a year just prior to meets. It is sent FREE to all N.M.R.A. members in the C.I.D. and non-members may subscribe for \$5 per year. Articles for publication are welcome for the benefit of the readers and the hobby but cannot be paid for. Submit articles for publication to the Editor; address changes or mailing problems to the Circulation Manager; and advertising or advertising inquiries to the Editor.

### Superintendent:

Larry Gilbert  
6675 S. 200 E  
Markleville, IN 46056  
Ph. 765-779-4039

### Asst. Superintendent:

Thomas Cain  
6383 Dover Road  
Indianapolis, IN 46220-4551  
Ph. 317-475-7834

### Chief Clerk:

Al Kohut  
7536 Rosslyn Ave.  
Indianapolis, IN 46240  
Ph. 317-466-0033

### Circulation Manager:

Jim Wilhite  
4823 Buttercup Way  
Anderson, IN 46013  
Ph. 765-644-1887

### Editor/Webmaster

Roger Hensley  
602 E. 31st Street - Anderson, IN 46016  
Ph: 765-649-2367 - [madisonrails@railfan.net](mailto:madisonrails@railfan.net)



# Central Indiana Division N.M.R.A. <http://cid.railfan.net/>

## Model Railroad Show and Meet Sunday – March 30, 2003

**Location:** 4-H Building - Hendricks County Fairgrounds  
Old U.S. 36 Danville, IN

**Time:** 10 AM to 3 PM

**Admission:** \$3.00 per person.  
Children 12 and under FREE with paying Adult

**Dealer Tables - Operating Layouts - Contests - Door Prizes**

**Dealer Tables \$12 ea [8 foot] & \$10.00 ea [6 foot]- Set Up 8:00 AM to 10:00 AM**

**Contact: Frank Hermanek at (317) 487-6517**

**Activity Schedule:**

10:30 - CID Annual Meeting & State of the Division Report

**Scheduled Clinics:**

KIT, "Basic Soldering" by Jim Wilhite, and "Digital Photography & Model Railroading" by Al Askerberg.

**Notice:** The CID KIT (Kids In Trains) Clinic will be the first clinic. This is a young modeler's 'Make and Take' Clinic where the young modeler assembles a simple kit with the aid of N.M.R.A. members. The CID will furnish both the kit and the tools and the completed kit is theirs to take home.

### Photo, Slide & Model Contests & Displays - All categories

#### Popular Vote Contest Favorite On-line Structure

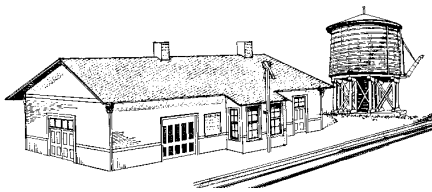

**Door Prizes  
good at any dealer present  
on this day only.**

**Next CID Meet:  
September 27, 2003 at Bedford IN**

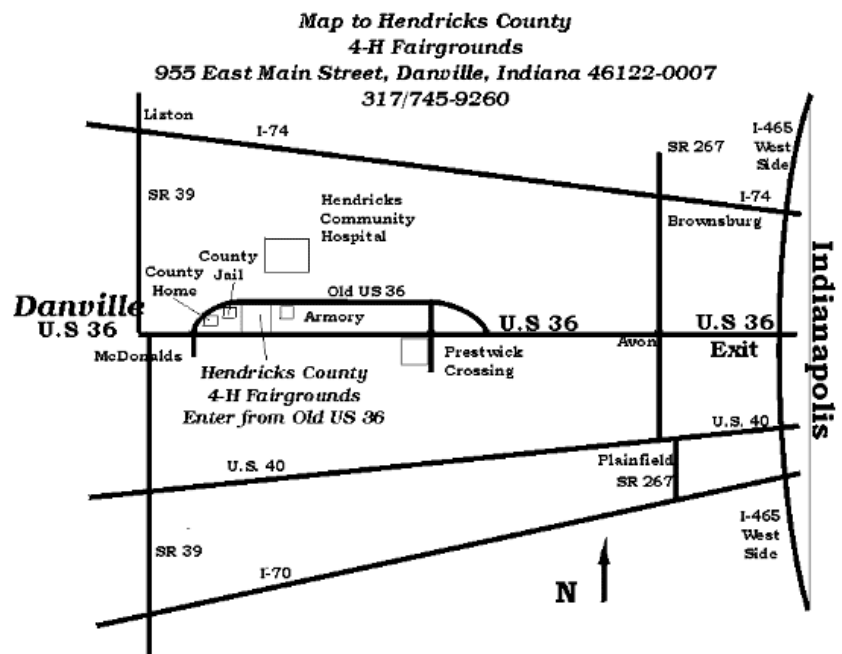



**Notice:** The **CID KIT (Kids In Trains) Clinic** is the first clinic at Meets. It is the young modeler's 'Make and Take' Clinic where young modelers assemble a simple kit with the aid of **N.M.R.A.** members. The **CID** furnishes both the kit and tools and the completed kit is theirs to take home.

**Kids In Trains Report**  
By **Bob Morrison**

The whole meet was pretty busy for all of us. We need more men & women on the job at the old KIT table. As Al Kohut said, he started with one of the KIT Kids so I could leave the KIT table to announce Greg Harter's Clinic and get him started. I relieved Al so he could get back over to see Greg's clinic. Thanks to James Treep and Marguerite for working so hard with all of our students. KIT was scheduled for 10:30 to 12:30 but we ran until 1:30 to get though all the kids. We didn't have anyone at first but when they came they all came at once just before and during Greg's Clinic. I had to turn away a man with 3 kids who came up at 1:45 after I had packed up.

Neither James nor I could do anymore. We had 11 kids in all with 10 boys and 1 young lady. 7 of our 11 participants were age 5 1/2 to 6, so it took a lot longer to complete the kits with these younger ones. I have the sheet and all included their phone numbers to be included in the drawing for the Train set after the Bedford meet. The participants were:

- |                  |         |               |         |
|------------------|---------|---------------|---------|
| Wesley Arends    | - 5 1/2 | Jimmy Fuller  | - 7     |
| Beth Biever      | - 9     | Nick Jones    | - 9     |
| Dominic Biever   | - 6     | Alan Libby    | - 5 1/2 |
| Conner Chapin    | - 7     | Ryan Sharkey  | - 6     |
| Charlie Cummings | - 6     | Joey Stebbins | - 5 1/2 |
| Conner Emery     | - 5 1/2 |               |         |

As for the other Clinics they were both well attended. I did not get a count of those at Al's clinic but Greg had 25 people at the beginning and I saw others heading that way.

**NMRA Web Site:**  
<http://www.nmra.org/>

**Noblesville Model Contest Report**  
By **Tom Cain**

**Favorite Train Contest (Popular Vote)**

- 1st** Bill Litkenhous – Bedford  
Amtrak Passenger Train - HO
- 2 Athearn Genesis AMD103 locomotives in the latest Amtrak paint scheme with 7 passenger cars including diner, lounge car and sleepers and coaches.

- 2nd** Tom Cain – Indianapolis  
Santa Fe Freight Train – HO  
Alco diesel locomotive with 4 cars & caboose.

**Favorite Open Load Contest (Popular Vote)**

- 1st** Tom Cain - Indianapolis  
50' Monon Flat Car with  
corrugated pipe load - HO
- 2nd** Trevor Jones – New Palestine  
2 Flat Ccars with military tank loads – N
- 3rd** Robert Morrison - Columbus  
50' Gondola with scrap metal loads – HO

**Structures – 1 entry**

**Bronze Award**

James Canter - Beech Grove  
Sand Building - O

The building was made of wood material, some of which was cut and pieced together for the front door. James used toilet paper specially cut and painted to represent a tarpaper roof. This model qualified for a "Bronze Award" using the new CID proposed 'Judging Guidelines.

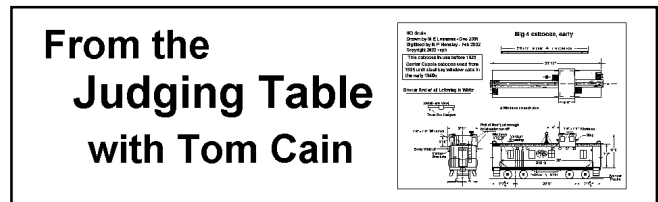

**Model Contests or Model Judging**

In the last few months the Central Indiana Division Board Members have had some online discussions related to model contests at our division meets. We have talked some about how to encourage more participation and some about why CID members choose to or not to participate in the contests. It seems that most people enter the contests because they want to either see how well their model skills are developing or to share with others what they have accomplished in the quality of their

(Continued on Page 5)

**(Contests or Judging continued)**

modeling. Both of these ideas really have nothing to do with competition or seeing who is better than the other. When I have talked with members who have brought in models for judging they seem more proud of what they have accomplished rather than seeing if their model was the best.

When I brought my models in for judging my hope was not to be "number one" but instead to reach that target score of 87 1/2 points or better that qualifies a person for an Achievement Award. It shows that a person has reached a higher level of workmanship. It is also satisfying to know that others recognize what you can accomplish. If that is the case, it makes more sense to do model judging and not model contests. What we are proposing is that the current point system in use by the NMRA be used to place modeling accomplishment into one of four levels. We are proposing that any model that scores at 87 1/2 points be given a "Gold Award." Any model that receives 76 - 87 points would receive a "Silver Award," and a model that scores 50 - 75 points would receive a "Bronze Award." Models with scores below 50 points would receive a "Participation Award." We have never had a "letters" section in the Rusty Spike, but I am sure that if you write to the Editor, he will publish it as he is always looking for articles or people who would like to contribute. You can also share your opinion on-line by participating in the CID discussion list. Those in the Central Indiana Division can join that list by sending your name, address, NMRA member-number (if any), and email address to: cidlist-request@lists.nmra.org

When I have viewed models at contests, I have enjoyed seeing the fine quality of detail work that others have built into their models. Most modelers have enjoyed hanging around the contest area and answered questions about their work. Listening to them and looking at their work can be as informative as a clinic or a good quality magazine article. Sometimes seeing how someone has added some special details to a model might give you the inspiration to try doing the same on your models. It might inspire you to break open one of those fine model kits that has been on your "to do" shelf and put it together. It is my hope that model judging will encourage members to bring some of their work in for review and that others will come by the judging area to see what other members of our division have accomplished. It seems that this approach might be a better way to promote the hobby rather than seeing who might be the best. See you at the judging table.

*Thomas Cain*



**Model Railroad Layout Tour**

The CID layout tour of the finest model railroads in Lafayette, Indiana takes place Sunday, April 13, 2003, Noon to 5 PM. Join us as we experience the "Worlds Greatest Hobby" in action, and it's all free!

Everyone starts at Hawkins Rail Services, 3501 Union Street, Suite 6, in Lafayette, Indiana (765-742-5577) to pick up their copy of the "Tour Map".

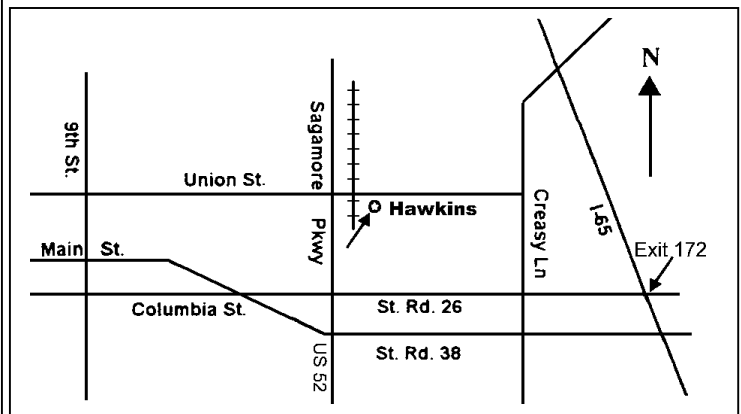

Maps will be available beginning at 10:00 am. Bring your shopping list and allow some time to browse Hawkins' extensive inventory of rolling stock and detail items when you go to get your map. You must see the store's HO layout and the 100+ car train.

There are 5 layouts on the tour. Each location has clear directions to the layout and instructions on how to enter. You choose the viewing sequence that best suits you; see one or see all five - its up to you! All layouts on the tour are HO scale; most are DCC operated.

Larry Swanson's Rio Grande from Salida to Montrose is a gorgeous double deck layout which was featured on the cover of the February 2002 issue of **Railmodel Journal**. If this is the only layout you see it will be worth the trip.

**(continued on Page 7)**

## And The Year Was 19 \_\_

*Page Six*

So, how many of you guessed 1985 as the correct date of John Reber's extensive, or should I say intensive, railfanning trip that was mentioned in his **Super Sez** column of the *Rusty Spike*?

Now, for this month try and guess when the following took place. The Spring meet was in Greenfield, IN where Trevor Jones' N Scale English Prototype Layout was displayed but NOT with a lot of scenery. Someone even wrote in the *Spike* that the layout "Is still being constructed and every time it's displayed more detail is noticed".

Funny thing but I still notice new detail every time I see Trevor's layout. The *Spike* noted the layout would be on display at the upcoming Convention. Also at the Convention a covered gondola was going to be on sale but lettered for the Wabash and not the Convention. The year was 19\_\_.

*Al Kohut*

**Pike Ads**

**Removed**

**See the Pike Ad**

**Web Page**

**For the Ads**

**Without address**

**Information**

**The Achievement Program  
Model Railroad Engineer, Civil  
Will be continued next issue**

## **Model Railroaders, the World's Greatest People**

**By Matt Hewitt**

Back in October at the end of the Great American Train Show (GATS), I was loading up all of my "How To," all day clinic items that included a section from my old Shadowton Ridge RR when I came down with a serious condition called 'Brain Fade'. (I'm sure that others have had the same condition.) You see, when I got home, an empty feeling hit me, for there, back at the Fairgrounds, on a concrete ledge, sat my beautiful one-of-a-kind, handmade, I can't believe that I forget it, Sawmill. @##!(% Nuts!

What do I do? I called Security at the Fairgrounds first. They did a search and said "Sorry. It's not here." Darn it! @##!(%, mutter, mutter, mumble, growl. Even though it was my own stupidity, I somehow couldn't believe someone would walk away with a handcrafted model and try to claim it as their own, especially when so many people had seen it. With that in mind, I called Roger Hensley for some ideas. So, quick thinking Roger posted it on the CID web site in hopes that someone did have it, but didn't know how to find the owner.

Then something special happened. No, the Sawmill wasn't found. It was an act of fellowship and friendship from one model railroader to another. At the next show at Pike High School in November, feeling my loss and for my help with promoting our hobby by bringing my items like the Sawmill, CID Board members offered whatever special assistance they could to try to help with replacing the model. I said that nothing was necessary, but they wouldn't hear of it. Their offer would stand. What can I say?

Models are models and they can be rebuilt, but friendships made in our great hobby, well, that's something you have forever. You feel so good by now, that I bet you completely forgot about the Sawmill. Well, so did I until the January GATS show. I started my search with the last person I saw outside at the Fairgrounds back in October, Harry Harrington with CINtrak. I asked him if he had seen the Sawmill and he said that he had. Getting excited, I ask if he saved it for me. He said no, but he did know who may have it and would hook me up with him if he showed up at the show.

A little later that day, Harry came back with great news. The Sawmill was found, was safe and was waiting for an owner. Our hero turns out to be Lou Bubala also with CINtrak. Lou said that he knew someone would be looking for it, so, he saved it hoping the owner would come forward.

I believed in the good of our hobby. We may be called a little odd for playing with trains and downright strange when we get excited when the Crossing Gates come down and we have to wait, but I'll take that strange any day knowing that model railroaders are the World's Greatest People.

*Thanks, Matt.*

Oh, by the way, I wonder if the CID Board will take some of my special ground up leaves and crushed burnt wood as repay. I wonder...

**Ed Note:** Nothing is needed, Matt. Your fellowship and sharing of your talents sets the pace for all of us. Although... my town of Westport does need more scenery work. HmMMM - rph

---

### **Lafayette Layout Tour (continued)**

Ted Luce's circa 1953 Chesapeake & Ohio has a PFM sound system with 80-85 % of the scenery complete. This large layout features both big steam and first generation diesels. Ted also has an extensive rolling stock collection of over 170 beer companies with no duplicates.

Ron Burkhardt's layout is presently a conversion in progress. He is converting his Rio Grande pike to a Western Maryland setting, which requires a complete change of landscape. Learn how Ron has kept the trains rolling in spite of the remodeling.

Tim Kirkoff recently completed a major expansion of his modern Union Pacific layout and regularly runs 50 to 60 car trains. Long runs and interesting operations will keep you glued to the action.

Chuck Tuttle has a huge double deck layout with long runs and helper grades. This may be the first time for many of us to see realistic helper service.

After the tour, join us at the Golden Corral for dinner (Dutch treat) and an informal chat session with other model railroad enthusiasts to compare notes, ask questions or just hang out. A great Sunday's entertainment at a price that just can't be beat!!

Questions? Need more information? Call James Treep at 317-844-6514.

*James Treep*

**Page Eight**

**Pike Ads**

**Have Been Removed**

**See the Pike Ad**

**Web Page**

**For the Ads**

**Without address**

**Information**

## The Depot

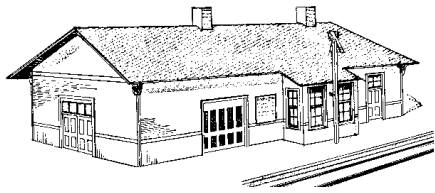

### Gestetners, Ballots, Meets & Tips

We are having to make some changes in how we put out the *Rusty Spike*. For years, we have been printing the *Spike* ourselves. We own the machine and one of our members, Paul Brown, has been printing it on our machine at its home in his basement. Ah, but time marches on and wear and tear take their toll on man and machine. The old Gestetner probably has printed its last *Spike*. This means that we will now have the *Spike* printed for us and the costs will increase exactly how much we aren't sure yet. This is not a problem today, but it may become one at some time in the future.

With this change, and the timing of the CID Election Ballot, if the ballot is printed on the Gestetner, it may be the last run for the old machine. It's time to retire it to a museum. So, watch for the ballot in the mail. It should be mailed back or returned at the Annual Meeting at the Danville Meet as usual. As a reminder, I would like to point out that only **NMRA** members living in the CID are eligible to vote and they should be the only ones receiving the ballot.

#### Meet locations

From time to time, I hear it said that we (the **CID**) never hold a Meet in their area. The **CID** covers much of Indiana and extends down into Kentucky. To hold a 'Meet' requires someone in a given area to act as a sponsor and make arrangements for a place to meet. For example, I can't do it from Anderson. Most meeting places require a local person to be responsible for the facilities.

What is needed? Well, it is not necessary to have dealers at a Meet. The Pike Meet has no dealers as it is designed to introduce the hobby to more people as part of our 'November is Model Railroad Month' activities. We do need space for two of three clinics, displays and model and photo judging. A trip to Evansville would probably require an overnigher for some of us up here. That's why someone there must be involved.

As a part of our series of Meets, we can supply fliers to be put at local hobby shops from here, put it in the *Spike* and on the **CID** web site, but we can't set up the location details. Speaking for myself, I would love to see **KIT**

reach more kids and see some of the local clinics that we don't get a chance to see up here.

Which brings up another possibility. Some other areas in the **NMRA** are now holding mini-meets in homes or small meeting rooms where they are not close to the main part of their division. Small groups are getting together every month or two for a 'How To' clinic or slide presentation on something of interest in the area, like the Penn Central or Illinois Central Railroad, etc. or even to visit someone's layout. This doesn't require a lot of space, but does require someone to coordinate these mini-meets and could probably work well in an area like Evansville where it is quite a distance from Bedford, Indy, Danville, Noblesville or even Terre Haute. I'm sure that some of the **CID** Board members would be happy to help get something like this started and I know that I would be pleased to carry information about the when and where in the *Spike*. After all, we're all in this together.

#### Modeling Tips

We have put Modeling Tips on the **CID** web site at <http://cid.railfan.net/> in order to share ideas with one another. This is just the beginning of the Tips pages. We would be pleased to add your ideas and tips to these pages as we have just scratched the surface of what we can share. Call, write or e-mail your tips to me at the address on page 2.

*Roger*

#### Weather or Not

It was a very cold and windy night in the switch yard. Most of the crew was out with the flu and they were very short handed for the switching work. The schedule was falling behind.

The Yardmaster called the far end crew on the radio and said, "What's going on down there? We're getting way behind schedule!"

A voice answered. "Hey, I'm the only one down here tonight and I'm doing the best I can!"

The Yardmaster replied, "Well, spread out!"

*Jim Wilhite*

**Rusty Spike Vol. 33 No. 2**  
© Copyright 2003  
**Central Indiana Division,**  
**Midwest Region, N.M.R.A.**

## **Mailer Page Ten**

These Commercial advertisers support the *Rusty Spike* with their advertising.  
Your patronage is appreciated.

### **Big Four Hobbies**

1005 East Main St.  
Plainfield, IN 46229  
(Across from PSI - 6 miles West of Airport on US 40)  
Ph. (317) 837-1024

### **Columbus Area RR Club**

President: Rich Rudder  
P.O. Box 2653  
Columbus, Indiana 47202-2653  
(Foxes Den, Camp Atterberry)

### **HobbyTown, USA**

Mars Center  
6336 East 82nd Street  
Indianapolis, IN  
Ph. (317) 845-4106

### **Train Central**

Wayne Maple  
6742 E. Washington Street  
Indianapolis, IN 46229  
Ph. (317) 375-0832